

Cable : RG142, RG223, RG400 & Equivalents

Pin arrangement

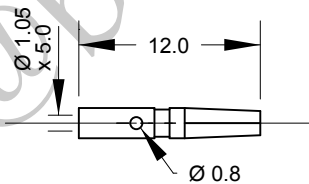

Note.
Supplied with heatshrink for crimp ferrule

Crimping Details

Crimp Pin Hex 0.068" (1.72mm)
Crimp Ferrule Hex 0.213" (5.41mm)

Crimp Tool Order Code:-
180455, 180456 & 180458

Cable Preparation

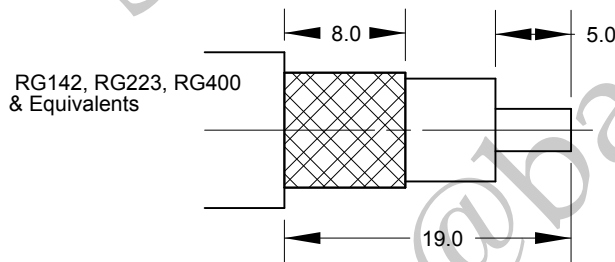

Cable Construction Specifications

	RG142	RG223	RG400
Inner Conductor	0.95mm	0.89mm	0.97mm
Dielectric	2.95mm	2.95mm	2.95mm
Overall Braid	3.96mm	4.00mm	3.96mm
Jacket	5.00mm	5.40mm	4.95mm

CODE	DESCRIPTION	MATERIAL	QTY	FINISH
3	SHELL/BODY	BRASS	1	NICKEL
2	INSULATOR	TEFLON	1	
1	PIN CONTACT	BRASS	1	GOLD

BARENCO Ltd

Barenco Ltd

Unit 14 Winterbeck Ind. Est. Orston Lane, Bottesford,
Nottinghamshire NG13 0AU. Tel. 0(44)1949 860400
Email.Sales@barenco.co.uk. Web.www.barenco.co.uk

DRAWN Name BPG

Dimensions: mm

Date 13/05/2021

Last Rev.

SCALE 1 : 0.5

TNC plug reverse
pin crimp for RG142,
RG223 & RG400

SIZE
A4

DWG NUMBER

165310B

REV -

SHEET 1 OF 1