

Panel Mounting Hole Cutout

End View
Nut, Serrated Washer and Neoprene removed.

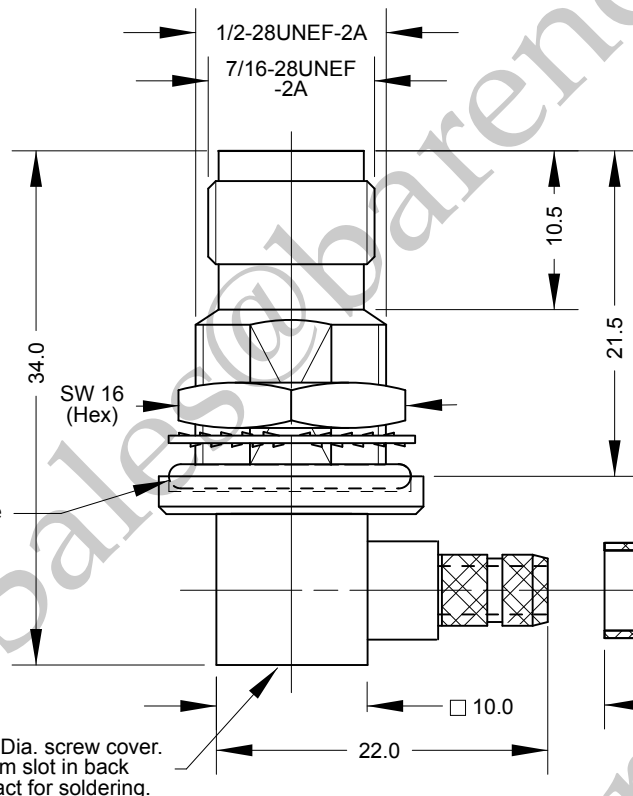
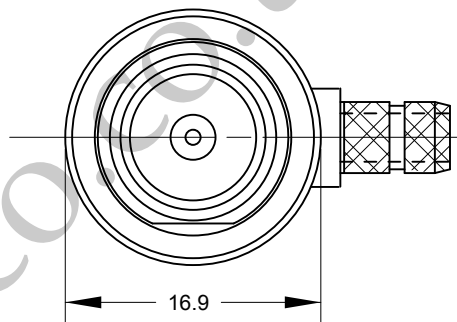

Note.
Supplied with heatshrink for crimp ferrule

Crimping Details

Crimp Ferrule Hex 0.213" (5.41mm)

Crimp Tool Order Code:-

180455, 180456 & 180458

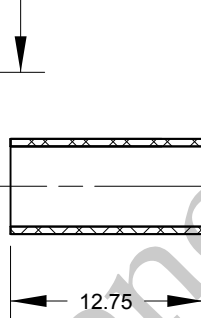

Cable : RG142, RG223, RG400
& Equivalents

Cable Preparation

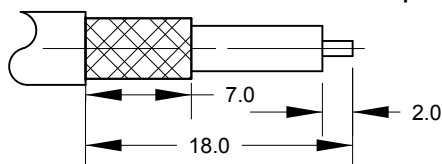

Cable Construction Specifications

	RG142	RG223	RG400
Inner Cond.	0.95mm	0.89mm	0.97mm
Dielectric	2.95mm	2.95mm	2.95mm
Overall Braid	3.96mm	4.00mm	3.96mm
Jacket	5.00mm	5.40mm	4.95mm

6	Ferrule	Phosphor Bronze	1	CuSnZn3
5	Nut	Brass	1	CuSnZn3
4	Crimp Ferrule	Brass	1	CuSnZn3
3	Shell / Body	Brass	1	CuSnZn3
2	Insulator	PTFE / Teflon	1	
1	Contact Socket	Phosphor Bronze	1	GOLD
CODE	DESCRIPTION	MATERIAL	QTY	FINISH

Barenco Ltd

Unit 14 Winterbeck Ind. Est. Orston Lane, Bottesford,
Nottinghamshire NG13 0AU. Tel. 0(44)1949 860400
Email.Sales@barenco.co.uk. Web.www.barenco.co.uk

BARENCO Ltd

DRAWN Name BPG

Dimensions: mm

Date 31/12/2020

Last Rev.

SCALE 1 : 0.5

TNC elbow bulkhead
socket crimp for RG142,
RG223 & RG400

SIZE

A4

DWG NUMBER

165335B

REV -

SHEET 1 OF 1