

Cable : RG213, RG214 & Equivalents

Pin and insulator arrangement

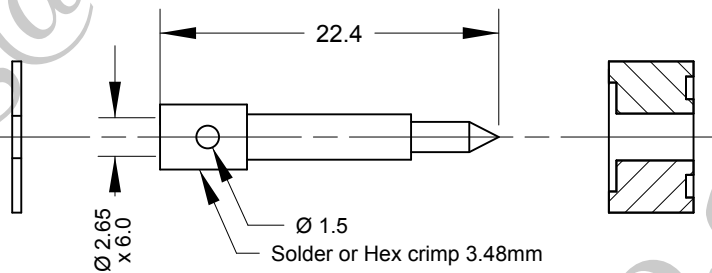

Cable Preparation

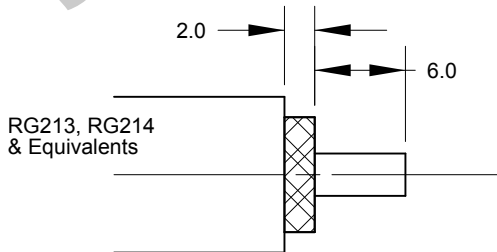

Crimping Details

Crimp Pin Hex 0.137" (3.48mm)

Crimp Tool Order Code:- 180456

Cable Construction Specifications

	RG213	RG214
Inner Conductor	2.29mm	2.29mm
Dielectric	7.25mm	7.25mm
Outer Conductor	8.00mm	8.00mm
Overall Braid	8.00mm	8.60mm
Jacket	10.30mm	10.80mm

	PART	DESCRIPTION
1	Shell/Body	Brass, CuSnZn3 Plated
2	Insulator	PTFE / Teflon
3	Pin Contact	Brass, Gold Plated
4	Nut	Brass, CuSnZn3 Plated
5	Neoprene	White

BARENCO Ltd

Barenco Ltd

Unit 14 Winterbeck Ind. Est. Orston Lane, Bottesford,
Nottinghamshire NG13 0AU. Tel. 0(44)1949 860400
Email.Sales@barenco.co.uk. Web.www.barenco.co.uk

DRAWN Name BPG

Dimensions: mm

Date 08/03/2020

Last Rev.

SCALE 1 : 0.5

**N plug clamp for
RG213 & RG214**

SIZE
A4

DWG NUMBER
168040

REV -

SHEET 1 OF 1