

Cable : ANT240, LMR240, RG8Mini & Equivalents

Cable preparation details

Pin and insulator arrangement

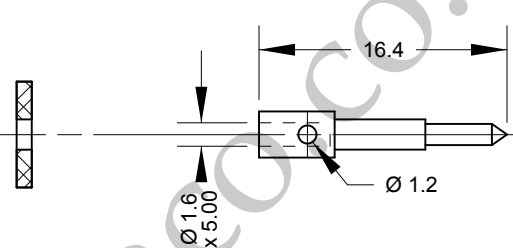
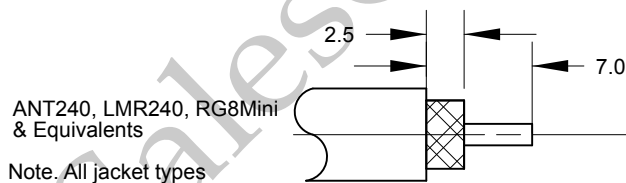

Note.

Solder centre contact

or

Centre conductor crimp Hex: 0.1" (2.54mm)

Crimp Tool Order Code:-

180454, 180456 & 180457

Cable Construction Specifications

	LMR240	RG8Mini	ANT240
Inner Conductor	1.42mm	1.47mm	1.42mm
Dielectric	3.81mm	3.90mm	3.81mm
Outer Conductor	3.94mm	4.25mm	3.90mm
Overall Braid	4.52mm	4.25mm	4.52mm
Jacket	6.10mm	6.10mm	6.10mm

PART	DESCRIPTION
1	Shell/Body Brass, CuSnZn3 Plated
2	Insulator PTFE / Teflon
3	Pin Contact Brass, Gold Plated
4	Nut Brass, CuSnZn3 Plated
5	Neoprene White

BARENCO Ltd

Barenco Ltd

Unit 14 Winterbeck Ind. Est. Orston Lane, Bottesford,
Nottinghamshire NG13 0AU. Tel. 0(44)1949 860400
Email.Sales@barenco.co.uk. Web.www.barenco.co.uk

DRAWN
Name

BPG

Dimensions: mm

Date

14/06/2020

Last Rev.

SCALE 1 : 0.5

BNC plug clamp
for ANT240, LMR240
& RG8Mini

SIZE

A4

DWG NUMBER

168150

REV -

SHEET 1 OF 1