

Cable : ANT240, LMR240, RG8Mini & Equivalentents

Cable preparation details

ANT240, LMR240, RG8Mini & Equivalentents  
All jacket types

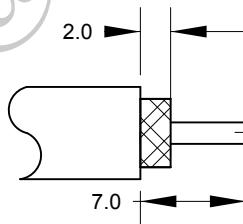

Pin & Insulator arrangement

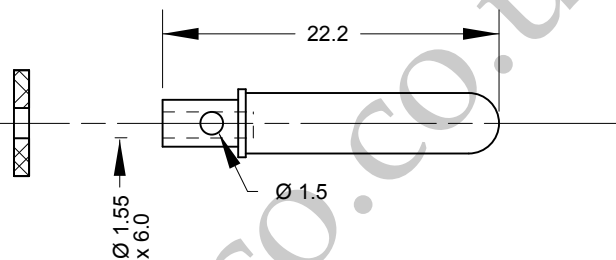

Note.

Solder centre contact  
or

Centre conductor crimp Hex: 0.1" ( 2.54mm )

Crimp Tool Order Code:-

180454, 180456 & 180457

Cable Construction Specifications

	LMR240	RG8Mini	ANT240
Inner Conductor	1.42mm	1.47mm	1.42mm
Dielectric	3.81mm	3.90mm	3.81mm
Outer Conductor	3.94mm	4.25mm	3.90mm
Overall Braid	4.52mm	4.25mm	4.52mm
Jacket	6.10mm	6.10mm	6.10mm

	PART	DESCRIPTION
1	Shell/Body	Brass, CuSnZn3 Plated
2	Insulator	PTFE / Teflon
3	Pin Contact	Brass, Gold Plated
4	Nut	Brass, CuSnZn3 Plated
5	Neoprene	White

**BARENCO Ltd**

**Barenco Ltd**

Unit 14 Winterbeck Ind. Est. Orston Lane, Bottesford, Nottinghamshire NG13 0AU. Tel. 0(44)1949 860400  
Email.Sales@barenco.co.uk. Web.www.barenco.co.uk

DRAWN Name BPG

Dimensions: mm

Date 03/03/2020

Last Rev.

SCALE 1 : 0.5

UHF plug clamp for ANT240, LMR240 & RG8Mini

SIZE A4

DWG NUMBER 168250

REV -

SHEET 1 OF 1