

Cable : LMR-600 & Equivalents

Pin and insulator arrangement

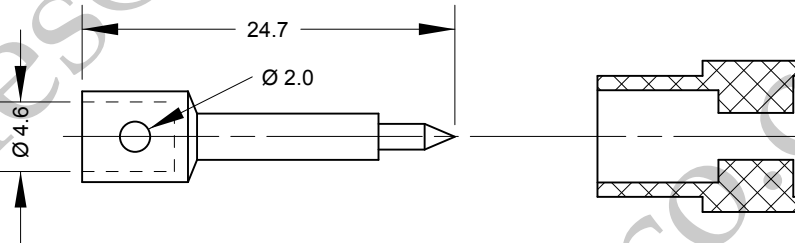

Pin can be soldered or crimped as required

Cable Preparation

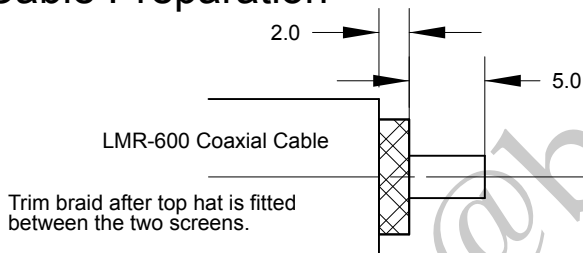

Crimping Details

Crimp Pin Hex 0.213" (5.41mm)

Crimp Tool Order Code:-

180455, 180456 & 180458

Cable: Times Microwave LMR-600

Construction Specifications
 Inner Conductor 4.47mm
 Dielectric 11.57mm
 Outer Conductor 11.71mm
 Overall Braid 12.45mm
 Jacket 14.99mm

	PART	DESCRIPTION
1	Shell/Body	Brass, CuSnZn3 Plated
2	Insulator	Teflon
3	Pin Contact	Brass, Gold Plated
4	Nut	Brass, CuSnZn3 Plated
5	Neoprene	White or semi translucent

BARENCO Ltd

DRAWN Name	B. Gell	N plug straight clamp for LMR-600	
Dimensions: mm			
Date	16/11/2019	SIZE	DWG NUMBER
Last Rev.		A4	168000
SCALE	1 : 0.5	REV	-
			SHEET 1 OF 1

Barenco Ltd

Unit 14 Winterbeck Ind. Est. Orston Lane, Bottesford, Nottinghamshire NG13 0AU. Tel. 0(44)1949 860400 Email.Sales@barenco.co.uk. Web.www.barenco.co.uk